

## Magnetic Flow Meters

### Balance Electrode Plane

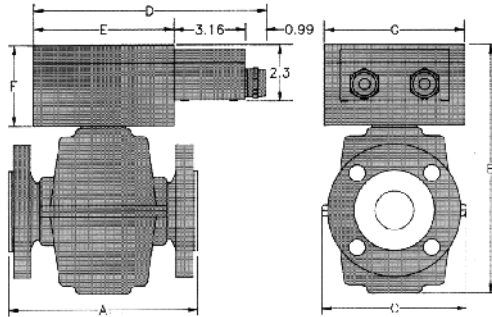

Meter Size	A	B	C	D	E	F	G
1"	7.88	9.72	5.25	10.45	6.30	3.63	6.30
2"	8.50	11.22	6.50	10.45	6.30	3.63	6.30
3"	13.13	14.97	10.00	10.45	6.30	3.63	6.30
4"	13.13	14.97	10.00	10.45	6.30	3.63	6.30
6"	18.27	23.03	13.80	10.45	6.30	3.63	6.30
8"	18.68	23.73	13.80	13.16	9.00	4.33	13.00
10"	24.24	27.87	18.93	13.16	9.00	4.33	13.00
12"	24.90	27.87	18.93	13.16	9.00	4.33	13.00

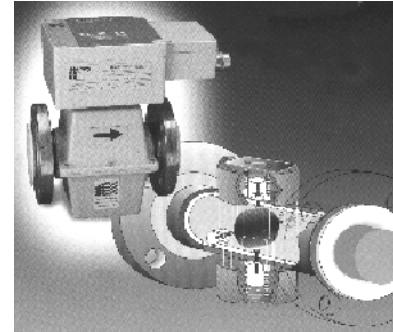

### Accessories

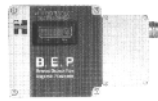

#### Local or Remote Rate Indicators/Resetable Model 100

Enclosure: NEMA 4, 4x, 12 and 13  
 Display: LCD, 0.43" high character  
 Rate Indicator: 4 digits (5 digits with added right zero), scalable from 0.001 to 9999. 5 position programmable decimal.  
 Totalizer: 8 digits, scalable by 0.0001 to 100,000 (scale factor of 0.0000 = 100,000). 5 position programmable decimal.



#### Remote Rate Indicators/Resetable Totalizer Model 1150

Enclosure: exposition-proof type  
 Rate Indicator: 3.5 digits or 4.5 digits 0.35" high characters.  
 Totalizer: 8 digits, 0.2" high  
 The 1150 is a two wire 4-20mA loop powered indicator/totalizer. Easy to program with menu prompts.  
 Calibration high and low values are fully programmable through keypad. External pulse output.



#### Rate Indicators/Totalizer/Controllers Model 1030 and 3030

Display: High visibilities, 16 characters, vacuum fluorescent display  
 Rate Indicator: 6 digits  
 Totalizer: 10 digits, scaled pulse output, remote reset capability for totalizer and set point outputs. It supplies 4 electronic outputs for driving light, alarms, chart recorders, and totalization for remote operations.

Typical Part # **610** **0** - **S** **0** **T** **5** **A** - **0** - **0000**

**Size**  
 6101 1" 6106 6"  
 6102 2" 6108 8"  
 6103 3" 6110 10"  
 6104 4" 6112 12"

**Electrodes and O-rings**  
 S 316 SS with Viron (std.)  
 H Hastelloy C w/ Kalrez (opt.)  
 T Tantalum with Kalrez (opt.)

**End Connections**  
 0 150 # RF ANSI Flange (std.)

**Liner Material**  
 T Teflon PTFE (std. on 1" to 12")  
 Y Polypropylene (6" to 12" optional)

**Output**  
 5 0 to 5,000 and 0 to 50 Hz. (std.)  
 1 0 to 10,000 and 0 to 100 Hz.

**Power Supply**  
 A 120 v ac (std.)  
 B 240 v ac

**Local Indicator/Totalizer**  
 0 None  
 1 Local Indicator/Totalizer

**Options**  
 0 No options  
 1 Remote transmitter (30' of cable std.)  
 2 3A Sanitary Authorization

---

**Accessories**

- Model 1000 Remote Rate Indicator/Totalizer
- Model 1150 Remote Rate Indicator/Totalizer
- Model 1030P Rate Indicator/Totalizer, panel mount. Requires 0 to 5,000 Hz output
- Model 1030W Rate Indicator/Totalizer, wall mount. Requires 0 to 5,000 Hz output
- Model 3030P Batch Controller/Indicator/Totalizer, panel mount. Requires 0 to 5,000 Hz output
- Model 3030W Batch Controller/Indicator/Totalizer, wall mount. Requires 0 to 5,000 Hz output
- Model 3030PK with panel kit of 3 large buttons, Requires 0 to 5,000 Hz output

